



FILE NO: ESR2810

SPECIFICATIONS

Rated Current: 1.5AMP
 Contact Resistance: 20mΩ Max
 Withstand Voltage: 500V AC/DC
 Insulation Resistance: 1000MΩ Min
 Operation Temperature: -40°C to +105°C

Contact Material: Brass

Contact Plating: Au or Sn Over Ni

Insulator Material: Polyester (UL94V-0)

Standard: PA6T

Max. Processing Temp: 230°C for 30-60 seconds
 (260°C for 10 seconds)

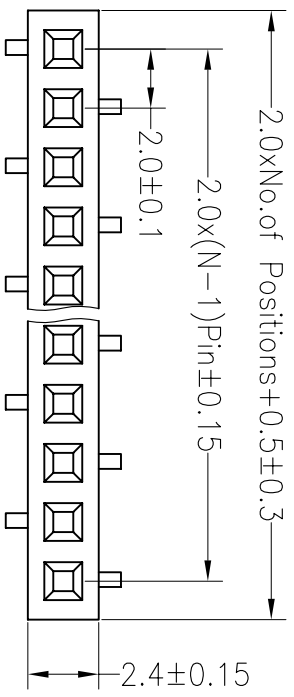

Recommended P.C.B. Layout (Top Side)
 (PCB BOARD TOLERANCE ± 0.05)

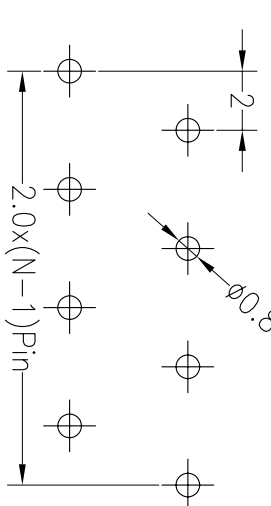

TYPE02

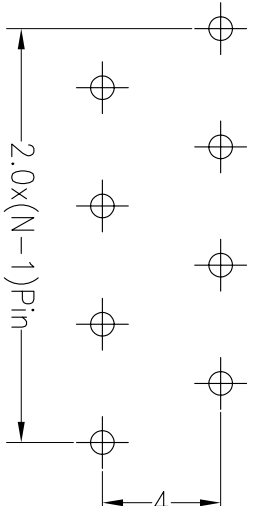
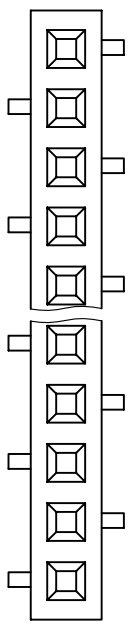

TYPE01

Ordering Information

2343 01 XX X N XX W U X 01

- No. of Pins Per Row: 1*40
- Insulator Material Option:
 - A=BK-FBT
 - B=BK-PA66
 - C=BK-PA6T
 - D=BK-PA46
 - E=BK-PA9T
 - F=BK-LCP
- Contact Plating:
 - G1: Gold Flash
 - G2: 1.5U" Gold
 - G3: 2U" Gold
 - G4: 3U" Gold
 - G5: 5U" Gold
 - S0: Gold Flash/Tin
 - SN: Tin
- Packing:
 - O=PE Bag
 - A=Tray
 - T=Tube
 - P=Tube+Cap
 - R=Reel+Cap
 - M=Reel+Mylar

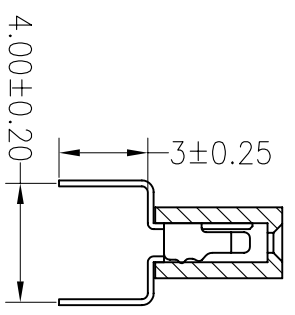
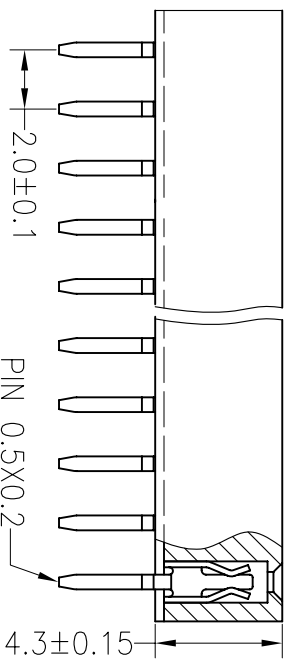

OPERATION		DRAW		SCALE		FIT	
X.X	±0.30	YHUSheng	12.04.18	UNIT	mm	A4	1/1
X.XX	±0.20	CHECK		SIZE			
X.XXX	±0.10			SHEET			
Angle	±3°	APPROVE		PROJ.			
DIM	TOL						

JIN 深圳市锦凌电子有限公司
 SHENZHEN JINLING ELECTRONIC CO.,LTD
 Tel: 86-755-2997-5806/5802 Fax: 86-755-2997-5992

PART NO. 234301XXXXXXWUX01

TITLE: 2.0PF H4.30mm 1XNpin 封装脚

REV	DATE	MODIFICATION DESCRIPTION	CHANGE
A0	2012.04.18	NEW DRAWING	